

- NOTES:
1. ALL WORKS SHALL BE CONSTRUCTED IN ACCORDANCE WITH THE NRA SPECIFICATION FOR ROAD WORKS.
 2. ALL DIMENSIONS IN METRES UNLESS SPECIFIED OTHERWISE.
 3. ALL CO-ORDINATES ARE TO IRISH TRANSVERSE MERCATOR (TM).
 4. ALL LEVELS ARE TO ORDNANCE DATUM AND ARE IN METRES.
 5. ALL TEMPORARY TRAFFIC & OPERATIONS MANAGEMENT SHALL COMPLY FULLY WITH THE NRA SPECIFICATION FOR ROAD WORKS.
 6. THE CONTRACTOR MUST LAISE DIRECTLY WITH MEATH COUNTY COUNCIL AS REQUIRED.
 7. ALL VEHICULAR & OPERATIONAL ROUTES WITHIN AND SURROUNDING THE WORKS EXTENTS MUST BE MAINTAINED THROUGHOUT THE WORKS IN ACCORDANCE WITH THE CONTRACTORS APPROVED TEMPORARY TRAFFIC & OPERATIONS MANAGEMENT PLAN AND SHALL COMPLY FULLY WITH THE PROVISIONS OF CH.8 OF THE TRAFFIC SIGNS MANUAL.
 8. CONTRACTOR SHALL EMPLOY THE SERVICES OF AN APPROVED SURVEY COMPANY TO ESTABLISH THE GRID IDENTIFIED IN THE MANAGEMENT PLAN AND SHALL COMPLY FULLY WITH THE PROVISIONS OF CH.8 OF THE TRAFFIC SIGNS MANUAL.
 9. ALL AGGREGATES PROPOSED FOR USE ON THIS SCHEME SHALL MEET FULLY THE REQUIREMENTS OF THE NRA SPECIFICATION FOR ROAD WORKS AND IN ADDITION THE REQUIREMENTS STATED IN STANDARD RECOMMENDATION S.R. 21:2014 GUIDANCE ON THE USE OF U.S. EN 13242-2002 +A1:2007 - AGGREGATES FOR UNBOUND AND HYDRAULICALLY BOUND MATERIALS FOR USE IN CIVIL ENGINEERING WORK AND ROAD CONSTRUCTION.
- DRAWING SPECIFIC NOTES:
1. REFER TO DRGS 170092-2000 TO 2004 FOR HORIZONTAL ALIGNMENT INFORMATION.
 2. REFER TO DRG 170092-2011 FOR TYPICAL CROSS SECTIONAL CONSTRUCTION DETAILS.

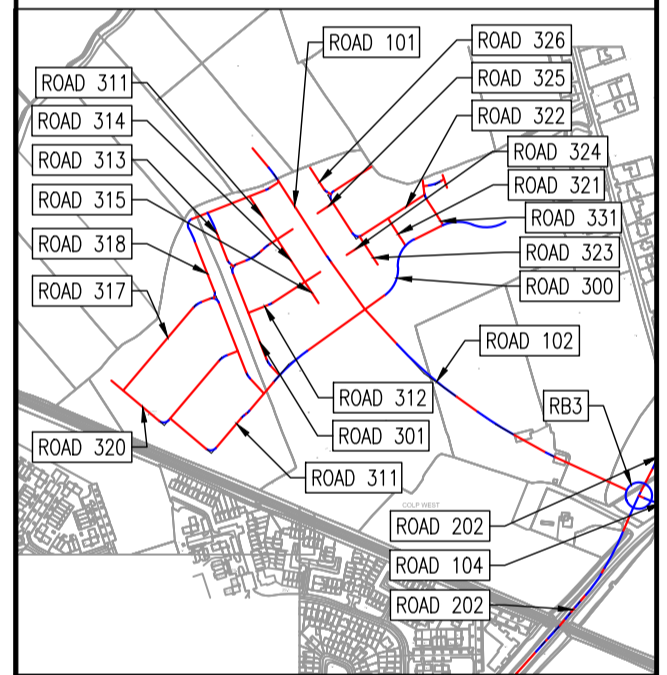
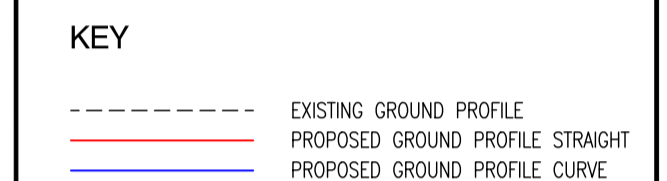

KEYPLAN

REV.	DATE	DESCRIPTION	BY	CHKD.
PLANNING SHD STAGE 3				
DESIGNED	DMW	PREPARED	DJG	
DATE	OCT 2019	CHECKED	DJR	

DBFL Consulting Engineers [email: info@dbfl.ie](mailto:info@dbfl.ie) [site: www.dbfl.ie](http://www.dbfl.ie)

Dublin Office: Ormrod House, Upper Ormrod Quay, Dublin 7, Ireland. PHONE: +353 1 400 4000 FAX: +353 1 400 4050

Waterford Office: Unit 2, The Chandlery, 1-2 O'Connell Street, Waterford, Ireland. PHONE: +353 51 308 500 FAX: +353 51 844 813

PROJECT
STRATEGIC HOUSING DEVELOPMENT AT COLPE WEST, DROGHEDA, CO. MEATH

DRG. TITLE
LONGITUDINAL SECTIONS THROUGH ROAD SHEET 4

CLIENT
SHANNON HOMES DROGHEDA LTD.

SCALE AS SHOWN @A1 FILE REF. 170092-2071
DRG. NO. **170092-2074**

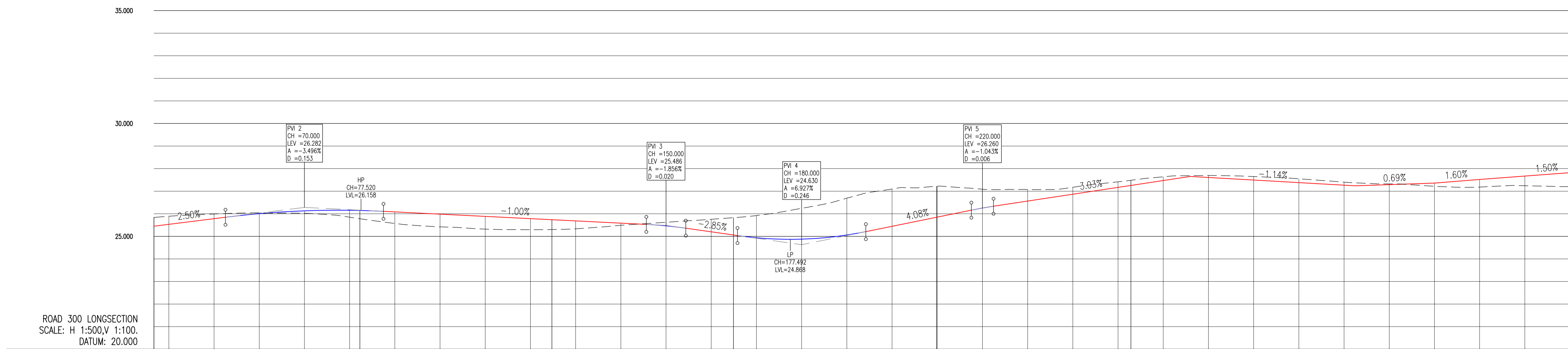

CHAINAGE	EXISTING GROUND LEVELS	PROPOSED LEVELS	VERTICAL GEOMETRY	HORIZONTAL GEOMETRY
36.898	25.537	25.450	G = 2.500% 1.40	R = 48.508 L = 45.358
40.000	25.890	25.532	R = 1000.000 K = 10.000 L = 34.961	
50.000	25.991	25.762	G = -0.996% -1.100	R = 49.620 L = 42.499
60.000	26.041	26.004		
70.000	26.024	26.130		
80.000	25.849	26.155		
90.000	25.570	26.083		
100.000	25.421	25.984		
110.000	25.321	25.884		
120.000	25.295	25.784		
130.000	25.332	25.685		
140.000	25.490	25.585		
150.000	25.623	25.465		
160.000	25.755	25.200		
170.000	25.919	24.937		
180.000	26.244	24.876		
190.000	26.692	25.059		
200.000	27.096	25.445		
210.000	27.220	25.853		
220.000	27.087	26.254		
230.000	27.076	26.563		
240.000	27.174	26.866		
250.000	27.415	27.170		
260.000	27.639	27.473		
270.000	27.698	27.609		
280.000	27.650	27.495		
290.000	27.550	27.381		
300.000	27.402	27.266		
310.000	27.324	27.291		
320.000	27.217	27.360		
330.000	27.183	27.500		
340.000	27.242	27.670		
350.000	27.207	27.820		

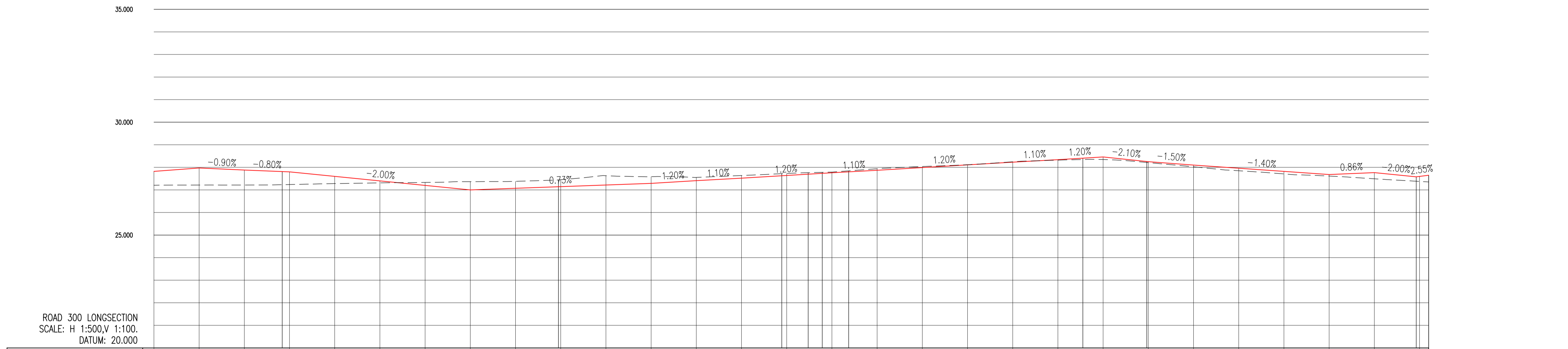

CHAINAGE	EXISTING GROUND LEVELS	PROPOSED LEVELS	VERTICAL GEOMETRY	HORIZONTAL GEOMETRY
350.000	27.507	27.820	G = 1.500% 1.67	L = 125.546
360.000	27.215	27.970	G = -0.900% -1.111	
370.000	27.216	27.880	G = -0.800% -1.125	
380.000	27.238	27.800	G = -2.000% -1.150	
390.000	27.280	27.600		
400.000	27.311	27.400		
410.000	27.331	27.200		
420.000	27.385	27.000		
430.000	27.380	27.072		
440.000	27.451	27.145		
450.000	27.630	27.217		
460.000	27.585	27.290		
470.000	27.553	27.410		
480.000	27.638	27.520		
490.000	27.730	27.640		
500.000	27.791	27.760		
510.000	27.839	27.870		
520.000	28.035	27.990		
530.000	28.116	28.110		
540.000	28.245	28.230		
550.000	28.320	28.340		
560.000	28.346	28.460		
570.000	28.209	28.250		
580.000	28.024	28.100		
590.000	27.850	27.960		
600.000	27.708	27.820		
610.000	27.613	27.680		
620.000	27.493	27.766		
630.000	27.326	27.598		
632.027	27.352	27.650		